



Glencoe Gardens | Kippax | LS25 7QY

£180,000

Three Bedroom Mid Town House | Council Tax Band A | EPC Rating TBC

**Emsleys** | estate agents

**\* THREE BEDROOM MID TOWN HOUSE \* NO CHAIN! \* THROUGH DINING KITCHEN \* THREE GOOD SIZED BEDROOM \* WHITE BATHROOM SUITE \* LARGE REAR GARDEN \***

Delightful three bedroom mid-town house offers a wonderful opportunity for families and individuals alike. With three well-proportioned bedrooms, this property provides ample space for comfortable living. The home is fitted with double-glazing and gas central heating, ensuring warmth and energy efficiency throughout the year. Offered with NO CHAIN, adds to the convenience of the home!

The lounge serves as a perfect gathering spot which over looks the rear garden, while the large through dining kitchen is ideal for entertaining guests or enjoying family meals. The bathroom is fitted with a modern white suite and features a shower over the bath, catering to both relaxation and practicality.

One of the standout features of this property is a generous rear garden, predominantly laid to lawn, which offers a serene outdoor space for children to play, gardening enthusiasts to flourish, or simply for enjoying the fresh air.

This well portioned house in Kippax is not just a home; it is a canvas for your personal touch, ready to welcome you into a vibrant community. With its generous accommodation and desirable location, this property is sure to attract interest. Don't miss the chance to make it your own.





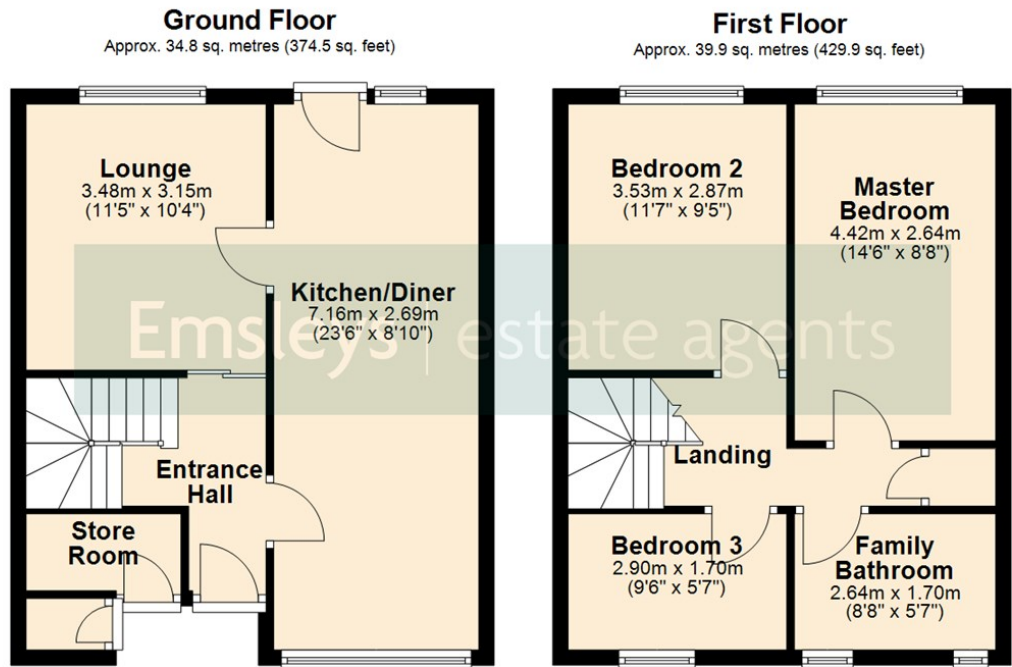

Total area: approx. 74.7 sq. metres (804.4 sq. feet)

These details are for guidance only and complete accuracy cannot be guaranteed. If there is any point, which is of particular importance, verification should be obtained. They do not constitute a contract or part of a contract. All measurements are approximate. No guarantee can be given with regard to planning permissions or fitness for purpose. No apparatus, equipment, fixture or fitting has been tested. Items shown in photographs are NOT necessarily included. Interested Parties are advised to check availability and make an appointment to view before travelling to see a property.



6 Main Street | Garforth | Leeds | LS25 1EZ  
t: 0113 286 4000 www.emsleysestateagents.co.uk

